

DETAIL A

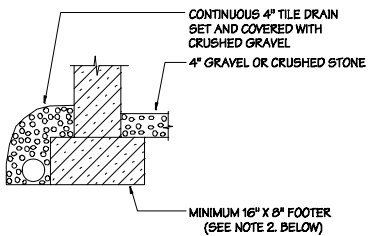

DETAIL B

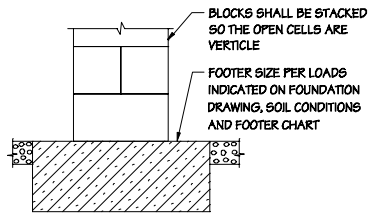

DETAIL C

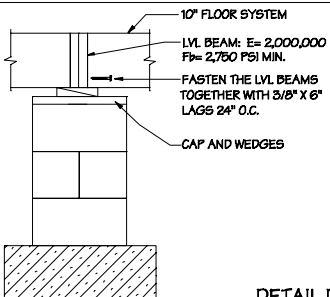

DETAIL D

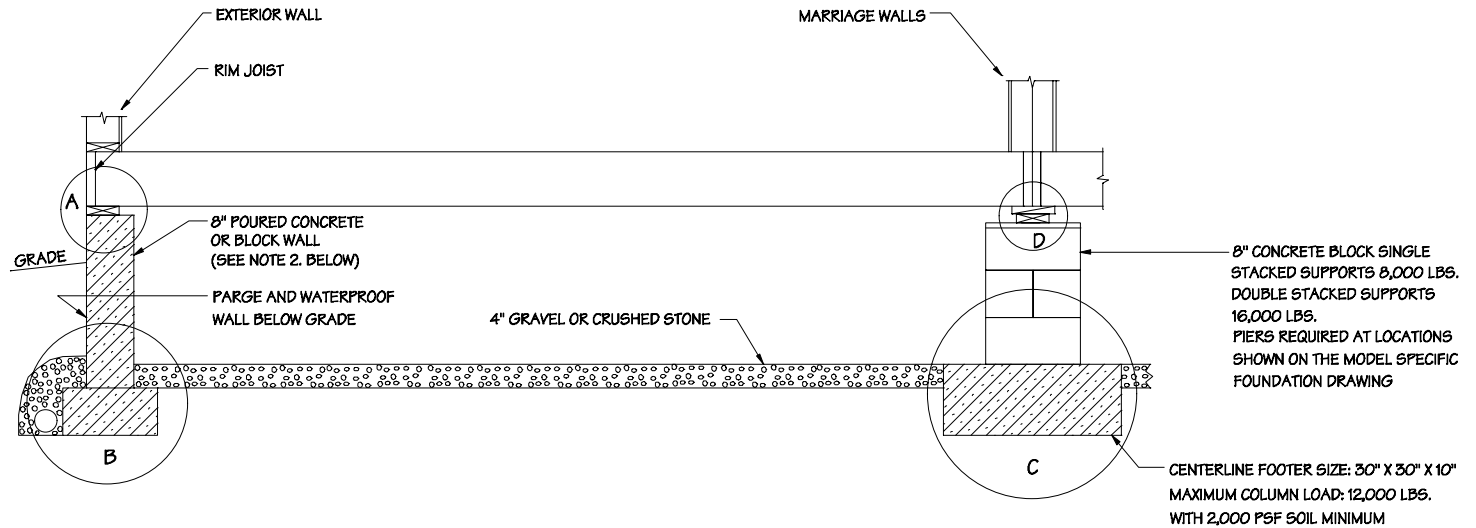

MINIMUM CONCRETE STRENGTH  
FOOTERS: 3,000 PSI  
FOUNDATION WALL: 3,000 PSI

Manufactured Housing Enterprises, Inc.  
09302 State Route 6 Bryan, Oh. 43506

SETUP MANUAL

CRAWLSPACE CROSS SECTION TYPICAL

Date: 6-8-99 Rev: 7-14-15 By: JB

NOTES: (SPANS ARE FOR 30 PSF GROUND GROUND SNOW LOAD)

- FOOTINGS TO BE DESIGNED FOR ACTUAL SOIL CONDITIONS OF THE SITE BY EITHER AN ENGINEER OR ARCHITECT. CONSIDER FROST LINES.
- THE LOCAL JURISDICTION MAY REQUIRE THICKER FOUNDATION WALLS AND OR FOOTING. IT IS THE BUILDERS/ DEALERS RESPONSIBILITY TO COMPLY WITH ALL LOCAL CODES.
- MAXIMUM SPAN OF MARRIAGE WALL OPENING WITHOUT COLUMN IS 47".
- MAXIMUM SPAN OF COLUMN SUPPORTS IS 10'-5".
- MAXIMUM SPAN OF COLUMN SUPPORTS WITH FLOOR LOAD ONLY IS 12'-10".
- CONCRETE MASONRY BLOCKS SHALL BE MORTARED PER LOCAL CODE REQUIREMENTS. MORTAR IS TO BE TYPE M OR S PER ASTM C-90.